

# 710

## **SEMI-AUTOMATIC DRILLING MACHINE MODEL "DISCOVERY 710"**

### **DESCRIPTION OF THE MACHINE**

DISCOVERY 710 is a semi-automatic drilling machine with opposite heads, with sensitive hand-operated upper drill and simultaneous automatic operation of the lower drill. It has a solid frame in electro-welded stainless steel with "C" shaped structure, typical of the drilling machines.

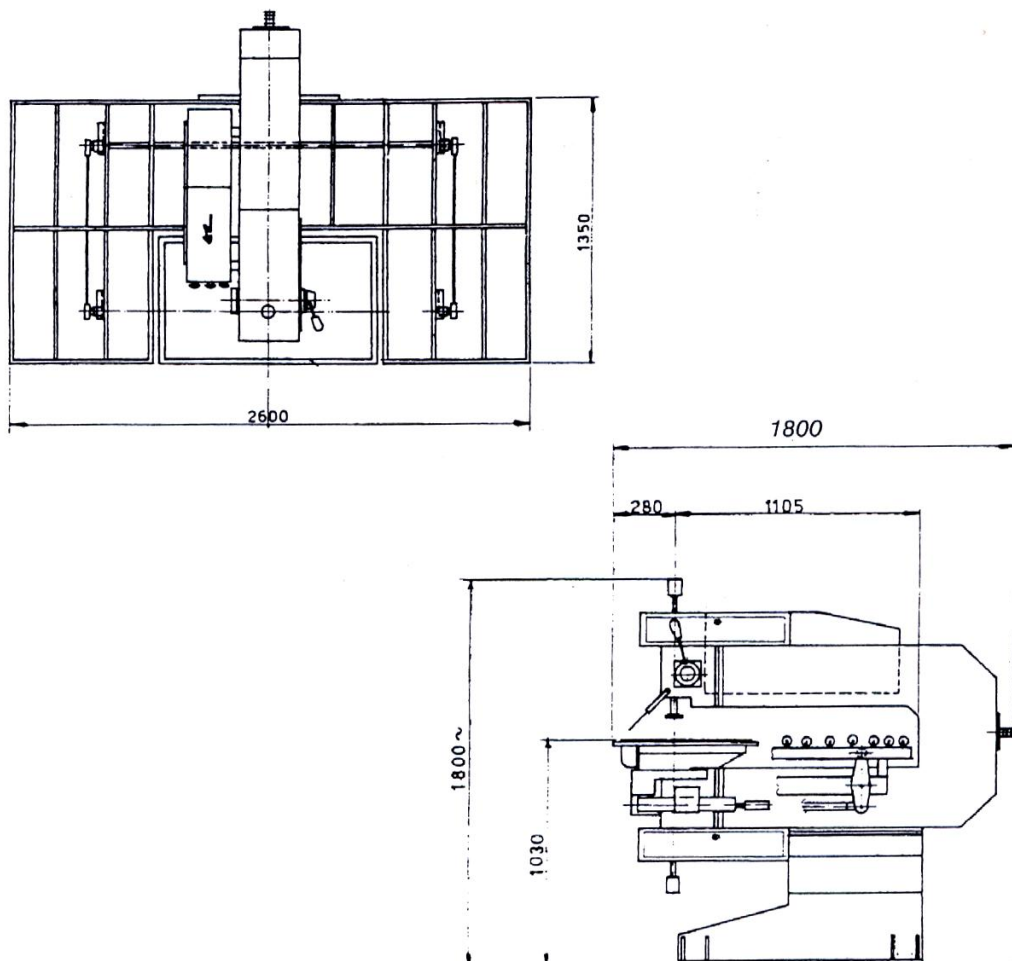

It is equipped with:

- Automatic glass clamping system
- 8 drilling speeds, from 470 to 3800 rpm
- automatic systems for the glass slugs ejection
- glass supporting table 1020 mm X 600 mm

### **DESCRIPTION OF THE DRILLING CYCLE**

This drilling machine is semi-automatic because during the upper drilling, the lower automatic drill operation is performed.

Upon holding and moving the drilling lever, these operations are automatically performed:

- 1) AUTOMATIC GLASS CLAMPING SYSTEM
- 2) QUICK APPROACH OF THE LOWER DRILL
- 3) SLOW DOWN TO WORKING SPEED
- 4) LOWER DRILLING COMPLETION
- 5) QUICK RETURN LOWER DRILL BIT
- 6) SLUG CONTAINER POSITIONING

After this, the drilling action is completed with the full upper drilling. Upon bringing back the lever to upper position, the carriage will automatically withdraw, dropping the slug.

### **MATERIAL INCLUDED IN THE BASIC SUPPLY**

- 2 pairs of drill bits (diameter Ø10 mm)

### **AVAILABLE OPTIONS**

- Laser centering device
- Pneumatic base table 2600 x 1350mm with pivoting wheels
- Squaring device for series drilling
- Water tank and pump

**GENERAL TECHNICAL SPECIFICATIONS**

Max. glass dimensions	1020 x 600 mm 2600 x 1350 mm (opt)
Overall dimensions	2600 x 1800
Total weight	600 Kg
Min. glass dimensions	80 x 80 mm
Glass thickness	1.8 - 55 mm
Max. possible hole diameter	3 – 140 mm
Max. rotation speed	3800 rpm
Max. possible weight	200
Installed power	5.5 KVA (5.5 KW)
Absorbed power	8 A
Operating pressure	Min. 6 bar
Work counter height	1030 +/- 40 mm

**WORKING CONDITIONS**

Environmental temperature	Storage -25°C to +70°C Working +5°C to +40°C
Humidity (working and storage)	90% at 20°C (w/o condensation) 50% at 40°C (w/o condensation)
Cooling water	pH 6.5 to 9 Chlorides (Cl-) ≤ 200 ppm Langelier Index (LSI) 0 to +0.4 Conductivity at 20 °C ≤ 800 µS/cm Total hardness ≤ 25 °f Solid particles size ≤ 100 µm Solid particles concentration ≤ 100 ppm
Power supply (without tension converter)	Voltage 400V (+/-10%) Frequency 50Hz Wiring 3PH+PE
Compressed air	Filtering 5 microns Dew point <5°
Waterproof equipment on control panel	IP65
Insulation	1500V input/output and logic to ground

**PROJECT AND PRODUCTION STANDARDS**

<p>The machine is designed, built and installed in consideration of the safety standards in force. Importance is placed upon the following aspects:          Easy approach.          Ergonomics at work.          Easy access to parts requiring maintenance.          Reliability of the machine and its components          Reduced noise levels.          Power savings.</p>	<p>Equipment in compliance with the European Standard, CE marking.          Guideline 2006/95/CE          Guideline 2006/42/CE          Guideline 2004/108/CE          CEI EN 60204-1</p>
---	---